

## NAMENA

Instalacione kutije su namenjene za spajanje instalacionih provodnika u uslovima gde je potreban veći stepen zaštite (IP55). Mogu se koristiti za kablove prečnika Ø9 - Ø14mm.

Izrađene su u skladu sa standardima IEC 60670-1 i IEC 60670-22 za temperaturno područje upotrebe od -25°C do +60°C.

Kutije sa stepenom zaštite IP55 mogu se koristiti i kao kućišta za ugradnju rasklopnih i sličnih uređaja (tasteri, releji, kontaktori i sl.). Pri tome se mora uzeti u obzir da svi otvori koji se izrade radi ugradnje moraju biti naknadno obezbeđeni odgovarajućim stepenom zaštite (min IP55 da bi se zadržao stepen zaštite kutije).



- Kućište nakon duže upotrebe pod uticajem sunčeve svetlosti može promeniti boju
- Deklarisani stepen zaštite može se postići samo pravilnom ugradnjom

## UPUTSTVO ZA INSTALACIJU

Kutiju otvoriti i kroz predviđene otvore pričvrstiti na podlogu. Koristiti **isključivo vijke prečnika 3,5 - 4,5 mm sa upuštenom glavom** radi obezbeđenja stepena zaštite. Vijci moraju biti pritegnuti da naležu čvrsto oko otvora na dnu kutije, ali ne previše da dođe do deformacije kutije. Deformacija kutije može prouzrokovati probleme sa zaptivanjem.

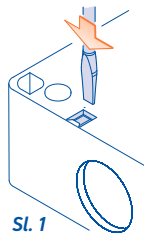

Sl. 1

- Ukoliko je potrebno napraviti otvore za oticanje vode izbiti izvijačem oslabljeno mesto (Sl. 1).

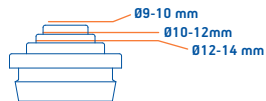

Sl. 2

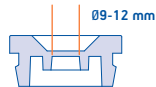

Sl. 3

Uvodnice pripremiti prema prečniku kabla prosecanjem kako je prikazano na Sl. 2 za otvorene odnosno Sl. 3 za zatvorene ulaznice. Obavezno voditi računa da ne dođe do neželjenog oštećenja ulaznice prilikom prosecanja.

Uvodnice utisnuti u otvore pazeći da nisu deformisane na unutrašnjoj strani.

Nakon uvođenja kablova i spajanja provodnika zatvoriti poklopac kutije. Vijke na poklopcu pritegnuti da se obezbedi dovoljan pritisak na zaptivku.



## MERE UPOZORENJA

- Prilikom instalacije obavezno isključiti električno napajanje (mrežni osigurač).
- Instalaciju može vršiti samo kvalifikovano osoblje sa odgovarajućim iskustvom.
- Voditi računa o pravilnom postavljanju ulaznica i zaptivke. Koristiti samo propisane vijke za montažu.

# ALING-CONEL

Nova Dimenzija Kvaliteta

SRBIJA • 21432 GAJDOBRA • Železnička 10  
TEL.: ++381 21/762-674, 762-586 • FAX.: ++381 21/762-779  
e-mail: info@aling-conel.com • www.aling-conel.com

## UPUTSTVO ZA INSTALACIJU I RUKOVANJE

**KUTIJA RAZVODNA  
ZA UGRADNJU NA ZID IP55**

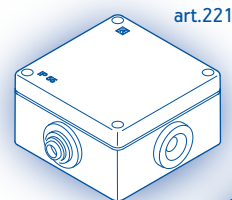

art.221

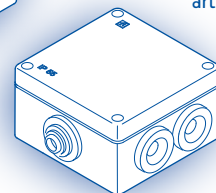

art.223

## PURPOSE

Junction boxes are intended for joining installation cables in conditions where a higher degree of protection is required (IP55). Can be used for cables of diameters  $\varnothing 9 - \varnothing 14$ mm.

They are made in accordance with the standards IEC 60670-1 and IEC 60670-22 for the temperature range of use from  $-25^{\circ}\text{C}$  to  $+60^{\circ}\text{C}$ .

Junction boxes with a degree of protection IP55 can be used as the housing for the installation of switchgear and similar devices (push buttons, relays, contactor...). Also, all openings for installation must be subsequently provided with an appropriate degree of protection (minimum IP55 to maintain the degree protection of the box).



- The housing may change the color after prolonged usage under the sunlight
- The declared degree of protection can only be achieved by proper installation

## INSTALLATION INSTRUCTION

Open the box and fix on base through the holes. Use **only screws with diameter 3,5 - 4,5 mm with countersink head** for degree of protection provide. Screws must be tightened to fit strongly around the hole, but not too much to cause box deformation. Deformation of box can cause sealing problems.

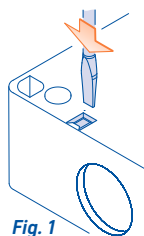

Fig. 1

- If it is necessary to make water drain holes, make them with the screwdriver on thinned place as shown on Fig. 1.

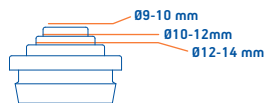

Fig. 2

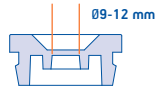

Fig. 3

Prepare the glands according to cable diameter with cutting shown on Fig. 2 for opened and Fig. 3 for closed glands. Be careful about gland damage during the cutting.

Push the glands into the holes making shure it wasn't deformed inside.

After cable placement and wires connecting close the box cover. Tight the screws on cover to provide enough pressure on gasket.



## GENERAL WARNING

- During the wire connection inside the box turn off the power suply (network fuse).
- Installation only by qualified persons with appropriate experience.
- Take care of correctly glands and gasket installation. Use only defined screws for installation.

# ALING-CONEL

New Quality Dimension

SRBIJA • 21432 GAJDOBRA • Železnička 10  
TEL.: ++381 21/762-674, 762-586 • FAX.: ++381 21/762-779  
e-mail: info@aling-conel.com • www.aling-conel.com

## INSTRUCTION MANUAL

**WALL MOUNTED JUNCTION BOX**  
**IP55**

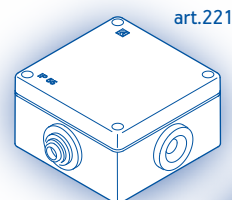

art.221

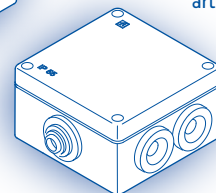

art.223